

THE ROOMS

IT ENDS HERE
Human nature and the road
to redemption or hell

THE BRUTALITY ROOM

Brutality is null, blank; its only content is brutality; it leads nowhere other than back to itself. There is no redemptive aspect to the relentless fact of brutality. And yet it is almost impossible, having been brutalised, not to become brutal.

THE RESISTANCE ROOM

To resist our tendency to retaliate is to resist our basest human nature. Resistance is the turn in the road away from hell towards grace. Grace may be as simple as the act of saying 'It ends here...'

THE IDIOCY & WISDOM ROOM

What seems like madness may be sanity, and what seems reckless may be wise. Idiocy and wisdom may appear similar as identical twins, and like identical twins, be impossible at times to tell apart.

THE ABUSE & PARANOIA ROOM

Abuse is the great teacher of how to abuse. The paranoid cannot discern between threat and the condition of his or her own paranoia. These aspects of human nature operate like serpents eating their own tails in an unbreakable cycle of further abuse and further paranoia.

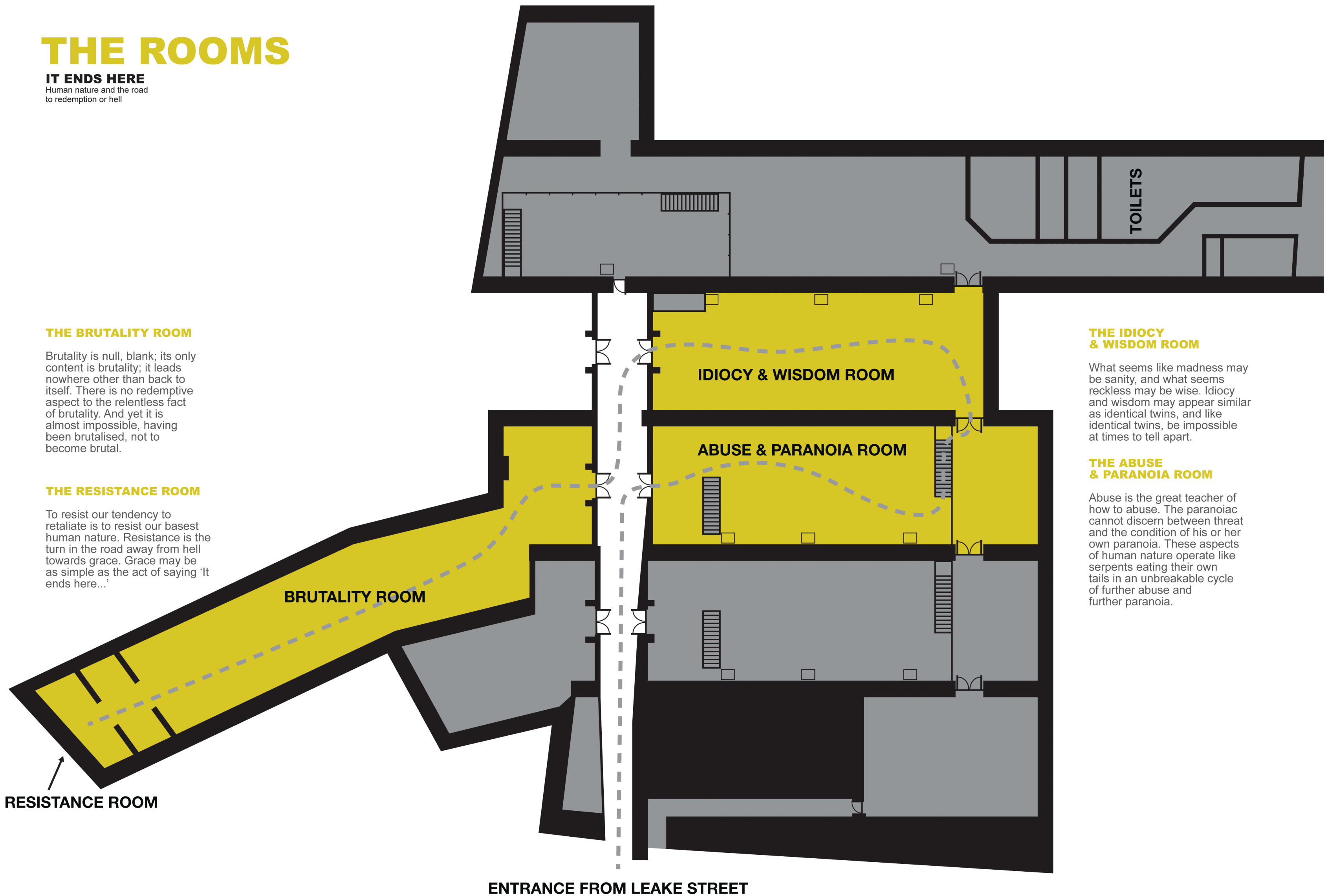

BRUTALITY ROOM

IDIOCY & WISDOM ROOM

ABUSE & PARANOIA ROOM

TOILETS

RESISTANCE ROOM

ENTRANCE FROM LEAKE STREET